

**GMS, INC.**  
**CONSULTING ENGINEERS**  
**611 NORTH WEBER, SUITE 300**  
**COLORADO SPRINGS, COLORADO 80903-1074**

**TELEPHONE (719) 475-2935**  
**TELEFAX (719) 475-2938**

**EDWARD D. MEYER, P.E.**  
**ROGER J. SAMS, P.E.**  
**JASON D. MEYER, P.E.**  
**DAVID R. FRISCH, P.L.S.**

**THOMAS A. McCLERNAN, P.E.**  
**MARK A. MORTON, P.E.**  
**KEN L. WHITE, P.L.S.**

**MEMORANDUM VIA ELECTRONIC MAIL**

**TO:** Louis Fineberg, Town Manager  
**City of Creede**

**DATE:** June 25, 2024

**FROM:** Margaret R. D'Amato, P.E.  
**GMS, Inc., Consulting Engineers**

**RE:** City of Creede  
307 South Loma Street  
Preliminary Engineer Evaluation

The purpose of this memo is to provide a preliminary engineer evaluation regarding disturbed groundwork at/near 307 South Loma Street in the City of Creede, Colorado. This evaluation is pertaining to properly covering and protecting an existing stormwater manhole and pipe that has become exposed due to adjacent groundwork. This evaluation is based on pictures provided by City staff and verbal discussion of the disturbance. A site visit did not occur. At a minimum, all recommended improvements should be installed by a qualified, licensed, and bonded contractor. Based on our evaluation, we have the following recommendations:

- Ground around stormwater manhole shall be restored with compacted backfill at a maximum slope of 3:1 for both cut and fill in all directions. Manhole lid shall not be set at or below surrounding grade, but a minimum of 6-inches above grade.
- Ground adjacent to the exposed section of pipe shall be restored with compacted backfill in accordance with the attached provided detail.
- Ground above the exposed section of pipe shall be restored with compacted backfill and provide a minimum of 2-feet of cover from the top of pipe in accordance with the attached provided detail.
- The existing stormwater structures shall rest on 3" of loose structure backfill in accordance with the attached provided detail.
- The site shall be graded so that stormwater is directed away from the manhole.
- Approximate limits of disturbance shall be restored with seeding and mulching. If the slope is 3:1 or greater, the slope shall be stabilized with erosion control blanket until final stabilization is achieved. Final stabilization shall be defined as a uniform vegetative cover with a density of at least 70% of pre-disturbed levels.

- It is recommended that temporary stormwater best management practices (BMPs) for runoff be installed during site grading and restoration to manage stormwater runoff and help reduce soil erosion.
- It is an understanding that further excavation has occurred to the edge of West 3<sup>rd</sup> Street. It is recommended that the City close West 3<sup>rd</sup> Street to traffic from both directions until the embankment is stabilized by a qualified contractor.
- It is recommended that an engineered retaining wall be designed and installed by a qualified contractor to the west and south of the property where slopes exceed 2:1.

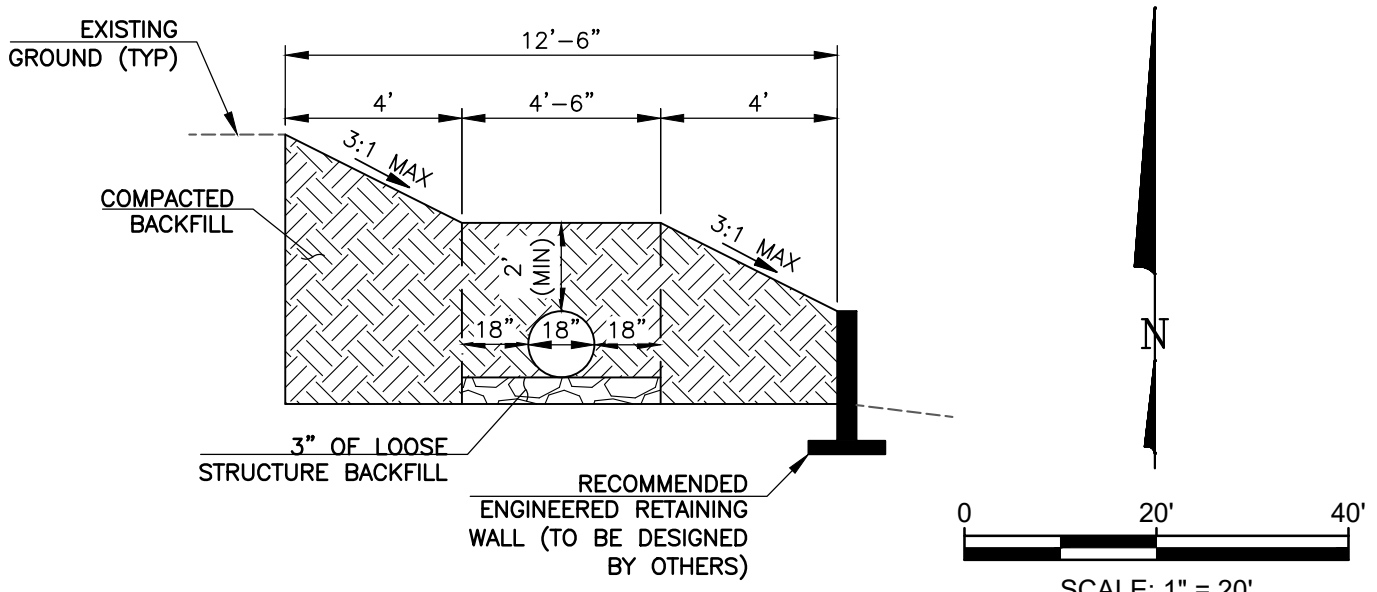
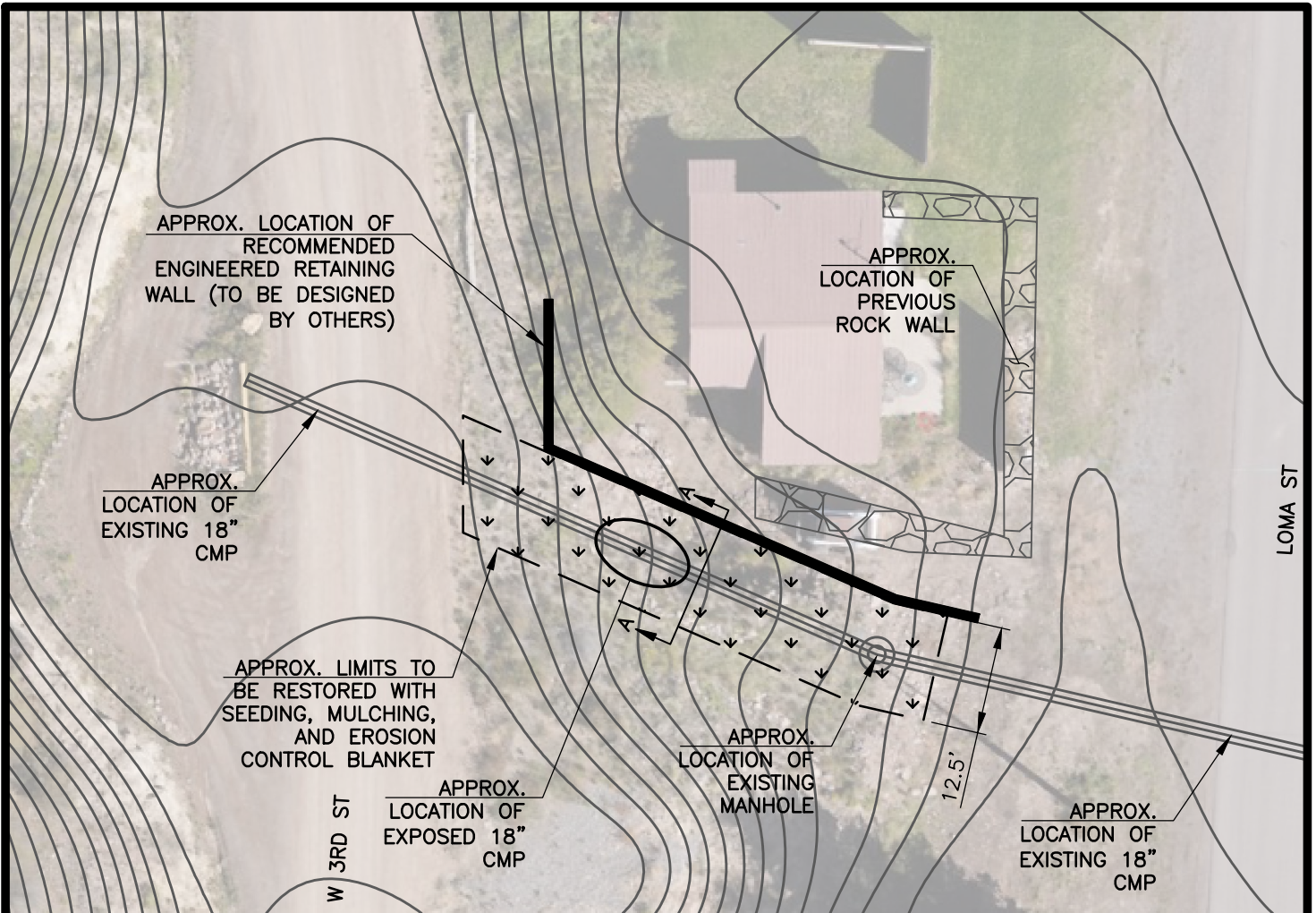

SECTION A-A

DETAIL.DWG

**NOTES**

1. ANY AREA DISTURBED DURING CONSTRUCTION ACTIVITIES SHALL BE RESTORED TO AS GOOD AS OR BETTER CONDITION THAN THOSE THAT EXISTED PRIOR TO THE CONSTRUCTION ACTIVITY.

**STORMWATER MANHOLE AND PIPE DETAIL  
ENGINEER EVALUATION  
CITY OF CREEDE**

**GMS, INC.**

CONSULTING ENGINEERS  
611 N. WEBER, SUITE 300  
COLORADO SPRINGS, COLORADO 80903

JUNE 2024

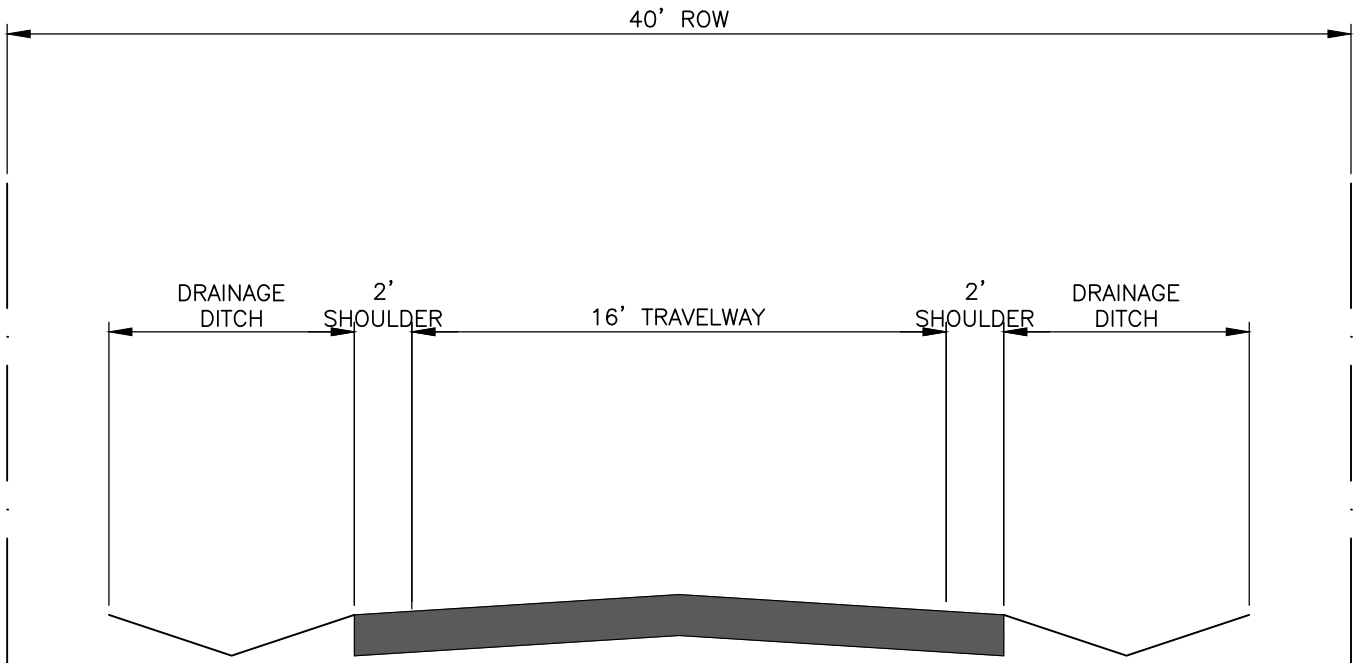

DETAIL.DWG

**RURAL GRAVEL LOCAL  
ROADWAY  
TYPICAL SECTION  
CITY OF CREEDE**

**GMS, INC.**

CONSULTING ENGINEERS  
611 N. WEBER, SUITE 300  
COLORADO SPRINGS, COLORADO 80903

JUNE 2024